

ENTEK CONSULTING GROUP, INC.

4200 Rocklin Road, Suite 7 Rocklin, CA 95677

Telephone (916) 632-6800

Fax (916) 632-6812

July 31, 2007

Mr. Leroy A. Christophersen, PHR
Safety & Loss Control Coordinator
Chico Unified School District
2455 Carmichael Drive
Chico, CA 95928

RE: Triennial AHERA Three-Year Reinspection

Dear Mr. Christophersen:

Enclosed is the data obtained from the AHERA Three-Year Reinspections Entek Consulting Group (Entek) conducted between April 11, 2007 and May 10, 2007. The documents included with this letter are the "Three-Year Reinspection Homogeneous ACBM Material Records" covering all buildings known from the original inspection to contain ACBM. The sites inspected were Academy for Change, Bidwell Junior High, Chapman Elementary, Chico Country Day, Chico Junior High School, Chico Senior High School, Citrus Elementary, Cohasset Elementary, Corporation Yard, District Office, Fair View High School, Hooker Oak Elementary, Loma Vista Elementary, Marigold Elementary, McManus Elementary, Neal Dow Elementary, Nord Elementary, Parkview Elementary, Pleasant Valley High School, Rosedale Elementary, Shasta Elementary, and Sierra View Elementary Schools. These are also provided on the enclosed diskette as per our contract. In an effort to assist with your Six-Month Surveillances, Entek has included on the CD blank forms with the current data from the Three-Year Reinspections.

You should review the updated Homogeneous Materials Reports to familiarize yourself with the current status of asbestos containing materials and identified suspect asbestos materials. It is the District's responsibility to assure that the school's site copy of the Management Plan is up to date and consistent with the District's Management Plan for that site. This is very important, and if not done can cause the District to be penalized during an EPA site visit or investigation.

Entek wants to remind you that materials containing "trace" amounts of asbestos must be considered in the event of renovations or demolitions. Although building materials containing trace amounts of asbestos (<1%) are not regulated under EPA, Cal/OSHA does regulate work practices with materials containing 0.1% asbestos. The original AHERA inspection contains information regarding materials with trace amounts of asbestos.

Entek collected two (2) asbestos bulk samples during the reinspections. One sample was collected at Loma Vista Elementary School and one at Chico High School. See the results of each sample in the following tables.

Loma Vista Elementary School; Unit A, North Building

Suspect Materials Found or Assumed TO Contain >1% Asbestos Content (RACM)			
Material	Asbestos Content	Location	Entek Sample Number
White 12" Floor Tile	1-5% Chrysotile	South East Corner of Room 16 Near Room 13	ECG-07-465-01A

Suspect Materials Found NOT TO Contain Asbestos or Considered Non-Suspect			
Material	Asbestos Content	Location	Entek Sample Number
Yellow Mastic	None Detected	South East Corner of Room 16 Near Room 13	ECG-07-465-01A



Mr. Leroy A. Christophersen, PHR
Safety & Loss Control Coordinator
Chico Unified School District
July 31, 2007
Page Two

Chico High School, Building LH-800, MPR

Suspect Materials Found NOT TO Contain Asbestos or Considered Non-Suspect			
Material	Asbestos Content	Location	Entek Sample Number
White Linoleum on Columns	None Detected	Building LH-800, MPR	ECG-07-465-02A
Yellow Mastic	None Detected	Building LH-800, MPR	ECG-07-465-02A

When you provide your annual notification to parents and staff, include information regarding this three-year reinspection. Enclosed is a suggested format for your notification letter. Please note that you must include in your Management Plans a description of the steps you take to notify. It is also important that your Management Plans be updated after any and all actions conducted which impact asbestos containing materials.

Please remember that Entek did not inspect new buildings or portable classrooms which were placed on the District sites since the original EPA AHERA inspection. It is the District's responsibility to obtain letters of certification from the Architect, Construction Superintendent, or manufacturer of new building materials, indicating there is no asbestos in the new buildings (constructed after October 12, 1988) or new building materials. A copy of these certification letters must be included in your Management Plans, both at the school site and at the LEA Designees office site. It is still required of School Districts to send a copy of these certification letters to the US EPA AHERA unit; Region IX in San Francisco.

It is not necessary to send a copy of the three-year reinspection to the OPSC or EPA. However, the report should be included in your Management Plan. I want to thank you for your cooperation. If you have any questions, please feel free to contact me at (916) 632-6800.

Sincerely,

William Esparza
Certified Asbestos Consultant
DOSH #99-2579

Enclosures

Below is a suggested letter to district personnel, building occupants, and parents that meets the AHERA requirement of annual notification. Regardless of the notification letter used, a signed and dated copy should be included in the Management Plan. The AHERA designee must also include in the Management Plan a brief statement describing the steps taken to notify. Include the date(s) of the six-month surveillances, and include any other actions taken with regards to asbestos.

Date:

To: Parents, PTA, Teachers, Maintenance, Staff

From: AHERA Designee

RE: Asbestos Hazard Emergency Response Act (AHERA) Asbestos Inspections and Management Plans.

Chico Unified School District has hired Entek Consulting Group, Inc. (Entek), to complete the required three-year reinspection of all asbestos-containing building materials in the District. The reinspections for Academy for Change, Bidwell Junior High, Chapman Elementary, Chico Country Day, Chico Junior High School, Chico Senior High School, Citrus Elementary, Cohasset Elementary, Corporation Yard, District Office, Fair View High School, Hooker Oak Elementary, Loma Vista Elementary, Marigold Elementary, McManus Elementary, Neal Dow Elementary, Nord Elementary, Parkview Elementary, Pleasant Valley High School, Rosedale Elementary, Shasta Elementary, and Sierra View Elementary Schools were completed between April 11, 2007 and May 10, 2007 by an accredited inspector, and the reinspection data has been incorporated into the Management Plan.

Also, during the past year the District has performed the required six-month surveillances on _____. This information is also incorporated into the Management Plan.

A copy of the District's Management Plan is available for review during normal office hours in the office of the _____. If copies of the plan are desired, a nominal duplicating fee may be charged.

Authorized Signature

Date

State of California
Division of Occupational Safety and Health
Certified Asbestos Consultant

William Esparza



Name

Certification No. **99-2579**

Expires on **05/03/08**

This certification was issued by the Division of
Occupational Safety and Health as authorized by
Sections 7180 et seq. of the Business and
Professions Code

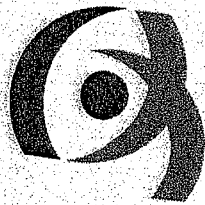

COEH CENTER FOR OCCUPATIONAL
& ENVIRONMENTAL HEALTH

University of California Berkeley

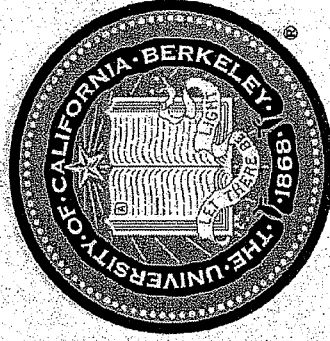

This certifies that

William Esparza

has attended the eight hour course

AHERA Refresher for Asbestos Inspectors & Management

Planners

and has completed the requisite training for asbestos accreditation under TSCA Title II

February 5, 2007

Course Date

John R. Schum

COEH Director

Date of Exam: February 5, 2007

Expiration Date: February 5, 2008

Barbara A. Plog

Continuing Education Director

Certificate Number: BIMP305

Cal/OSHA Approval Number: CA-002-06 / CA-002-08

Center for Occupational and Environmental Health Continuing Education Program

UC Berkeley Mailcode 5120, 2223 Fulton Street, 2nd Floor, Berkeley, CA 94720-5120 Ph: (510) 643-7277 Fax: (510) 643-7291

ASBESTECH
6825 Fair Oaks Blvd., Suite 103
Carmichael, California 95608
Tel.(916) 481-8902 Fax (916) 481-3975

Client:

Entek Consulting Group, Inc.
4200 Rocklin Rd., Suite 7
Rocklin, CA 95677

Job:

07-465 Chico USD
Loma Vista Elementary
Unit A, North Bldg., Chico, Ca

BULK ASBESTOS ANALYSIS REPORT

LAB JOB # 50277

Date/Time Collected: 5/10/07

Date Received: 5/21/07

NVLAP # 101442

DOHS # 1153

Date Analyzed: 5/22/07

<u>Sample No.</u>	<u>Color/Description</u>	<u>% Type Asbestos</u>	<u>Other Materials</u>
ECG-07-465-01A	White 12" floor tile, SE corner of room 16 near room 13	1-5 CHRYSOTILE	Granular Mins.
	Yellow mastic	NONE DETECTED	Synthetics

THE ANALYSIS USES POLARIZED LIGHT MICROSCOPY AND DISPERSION STAINING FOLLOWING E.P.A. METHOD 600/R-93/116. NON-FRIABLE MATERIALS WERE ANALYZED APPLYING THE SAME METHOD. THE LOWER DETECTION LIMIT IS <1 % WITH THE PROVISIO THAT PLM MAY NOT DETECT FIBERS <0.25 MICRONS IN DIAMETER THAT MAY BE PRESENT IN SAMPLES SUCH AS FLOOR TILES. IN ACCORDANCE WITH TITLE 22, CCR, SECTION 66261.24(a)(2)(A), THE MCL IS 1 %. SAMPLES WERE NOT COLLECTED BY ASBESTECH. THIS REPORT MUST NOT BE REPRODUCED EXCEPT IN FULL WITHOUT THE APPROVAL OF ASBESTECH. THIS REPORT RELATES ONLY TO THE ITEMS TESTED. THIS REPORT MUST NOT BE USED TO CLAIM PRODUCT ENDORSEMENT BY N.V.L.A.P. OR ANY AGENCY OF THE U.S. GOVERNMENT. ASBESTECH ACCEPTS TECHNICAL RESPONSIBILITY FOR THIS REPORT AND DATE OF ISSUE.

NVLAP

LABORATORY DIRECTOR: TOM CONLON

ANALYST: JIM JUNGLES



50277

BULK ASBESTOS MATERIAL *Analysis Request Form for Entek Consulting Group, Inc.*

4200 ROCKLIN ROAD, STE. 7
ROCKLIN, CA 95677
(916) 632-6800
FAX (916) 632-6812

JOB I.D.: 07-465 **CLIENT:** Chico Unified School District

COLLECTED BY: William Esparza

DATE COLLECTED: 05/10/07

DATE SUBMITTED: 05/21/07

LAB SUBMITTED TO: Asbestech

SPECIAL INSTRUCTIONS:

ANALYSIS REQUESTED: PLM with Dispersion Staining

TURNAROUND TIME: 24 Hours

JOB SITE: Loma Vista Elementary School
Unit A (North Building)
2404 Marigold Avenue,
Chico, California 95926

SAMPLE #	MATERIAL DESCRIPTION/LOCATION
ECG-07-465-01A	12" Floor Tile and Mastic, SE Corner of Room 16, Near Room 13

C:\Entek\Clients\Chico USD\07-465 Chico 3 Year Inspections\Bulk Asbestos Request 05-10-07.wpd

DELIVERED BY: Shannon Johnson

DATE: 5-21-07

RECEIVED BY: PAH

DATE: 5/21/7

ASBESTECH
6825 Fair Oaks Blvd., Suite 103
Carmichael, California 95608
Tel.(916) 481-8902 Fax (916) 481-3975

Client:

Entek Consulting Group, Inc.
4200 Rocklin Rd., Suite 7
Rocklin, CA 95677

Job:

07-465 Chico USD
Chico HS, Bldg. LH-800, MPR
Chico, Ca

BULK ASBESTOS ANALYSIS REPORT

LAB JOB # 50276

Date/Time Collected: 5/11/07

Date Received: 5/21/07

NVLAP # 101442

DOHS # 1153

Date Analyzed: 5/22/07

<u>Sample No.</u>	<u>Color/Description</u>	<u>% Type Asbestos</u>	<u>Other Materials</u>
ECG-07-465-02A	White linoleum on columns	NONE DETECTED	Vinyl Cellulose
	Yellow mastic	NONE DETECTED	Synthetics

THE ANALYSIS USES POLARIZED LIGHT MICROSCOPY AND DISPERSION STAINING FOLLOWING E.P.A. METHOD 600/R-93/116. NON-FRIABLE MATERIALS WERE ANALYZED APPLYING THE SAME METHOD. THE LOWER DETECTION LIMIT IS <1 % WITH THE PROVISIO THAT PLM MAY NOT DETECT FIBERS <0.25 MICRONS IN DIAMETER THAT MAY BE PRESENT IN SAMPLES SUCH AS FLOOR TILES. IN ACCORDANCE WITH TITLE 22, CCR, SECTION 66261.24(a)(2)(A), THE MCL IS 1 %. SAMPLES WERE NOT COLLECTED BY ASBESTECH. THIS REPORT MUST NOT BE REPRODUCED EXCEPT IN FULL WITHOUT THE APPROVAL OF ASBESTECH. THIS REPORT RELATES ONLY TO THE ITEMS TESTED. THIS REPORT MUST NOT BE USED TO CLAIM PRODUCT ENDORSEMENT BY N.V.L.A.P. OR ANY AGENCY OF THE U.S. GOVERNMENT. ASBESTECH ACCEPTS TECHNICAL RESPONSIBILITY FOR THIS REPORT AND DATE OF ISSUE.

NVLAP

LABORATORY DIRECTOR: TOM CONLON

ANALYST: JIM JUNGLES

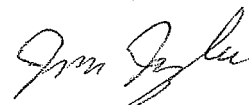

50276

BULK ASBESTOS MATERIAL *Analysis Request Form for Entek Consulting Group, Inc.*

4200 ROCKLIN ROAD, STE. 7
ROCKLIN, CA 95677
(916) 632-6800
FAX (916) 632-6812

JOB I.D.: 07-465 **CLIENT:** Chico Unified School District

COLLECTED BY: William Esparza

DATE COLLECTED: 05/11/07

DATE SUBMITTED: 05/21/07

LAB SUBMITTED TO: Asbestech

SPECIAL INSTRUCTIONS:

ANALYSIS REQUESTED: PLM with Dispersion Staining

TURNAROUND TIME: 24 Hours

JOB SITE: Chico Senior High School
Building LH-800, Multi-Purpose Room
901 The Esplanade,
Chico, California 95926

SAMPLE #	MATERIAL DESCRIPTION/LOCATION
ECG-07-465-02A	Linoleum on Columns

C:\Entek\Clients\Chico USD\07-465 Chico 3 Year Inspections\Bulk Asbestos Request 05-11-07.wpd

DELIVERED BY: Shannon Johanson

DATE: 5-21-07

RECEIVED BY: Roll

DATE: 5/24/7 10¹² AM

RECORD OF FRIABLE AND NON-FRIABLE ACM
(FORM B)

Inspection Date(s) May 10, 2007

THREE-YEAR REINSPECTION

SCHOOL Fair View High School (FKA Partridge Elementary School)					CDS CODE 04-61424-6003016	
ADDRESS (NUMBER) (STREET) (CITY) (ZIP) 290 East Avenue Chico, CA 95973					SCHOOL PHONE NUMBER (530) 891-3124	

-IMPORTANT-

Each building and functional space with friable ACMB or friable assumed ACMB listed on this form requires completion of FORM C (PHYSICAL AND HAZARD ASSESSMENT OF FRIABLE ACMB OR FRIABLE ASSUMED ACMB). Indicate location of material on blueprint, diagram or narrative in square or linear feet, and attach a copy (Sec. 763.93).

LINE	BUILDING NAME & FUNCTIONAL SPACE (Indicate Address if Different From Above)	CHECK ONE			CHECK ONE			
		SUR- FACING	TSI	MISC	ACBM		ASSUMED ACMB	
					FRIABLE	NON- FRIABLE	FRIABLE	NON- FRIABLE
1.	UNIT A			X				X
2.	UNIT B			X				X
3.	UNIT C (FKA A)	X		X		X		X
4.	UNIT D	X	X					X
5.	UNIT E	X		X				X
6.	UNIT F (FKA C)	X	X	X		X		X
7.	UNIT G (FKA B)	X		X		X		X
8.	UNIT H (FKA D)			X				X
9.	UNIT I (FKA D)			X				X
10.	UNIT J			X				X
11.	UNIT K			X				X
12.	UNIT L			X				X
13.								
14.								
15.								
16.								
17.								

See attached "Homogeneous Materials Records" for all materials and their locations by building. On Form B all buildings are listed, and a summary of all non-friable and friable material is provided. Friable materials and their locations are listed separately under each building on Form B.

THREE-YEAR REINSPECTION HOMOGENEOUS ACBM RECORDS

Date of Inspection: May 10, 2007

District: Chico Unified School District

Inspector: William Esparza

School: Fair View High School (FKA Partridge Elementary School)

Building: C - Classrooms 3-6 (FKA A)

Material Class	Material	Homo. Mat. #	% Asb.	FT ² /L.F.	Location	Condition: Code & Comments	Friable Yes/No
M	9" VFT	4	1-5%	4,500 S	CLASSROOMS 3-6 AND STAFF ROOM	(1) (4)	N
S	ACOUSTIC CEILING PLASTER	5	1-5%	5,000 S	CLASSROOMS 3-6 AND STAFF ROOM	(1)	N
M	TRANSITE PANELS	60	ASSUMED	8 PANELS	UNDER ENTRY WINDOWS, UNIT D	(7)	N/A

CONDITION CODE

General Condition: (1) Good (2) Damaged (3) Significantly Damaged (25% or more)
Change in Condition: (4) No (5) Yes (If Yes, explain under comments)
Abated: (6) Repaired (7) Removed (8) Encapsulated (9) Enclosed (10) Isolated & Restricted
Miscellaneous: (11) Inaccessible, no inspection data (12) Other (Explain under comments) (13) Non-Asbestos/Not Inspected

CONSULT ORIGINAL AND SUPPLEMENTARY INSPECTION REPORTS FOR MATERIALS WITH TRACE AMOUNTS OF ASBESTOS

THREE-YEAR REINSPECTION HOMOGENEOUS ACBM RECORDS

Date of Inspection: May 10, 2007

District: Chico Unified School District

Inspector: William Esparza

School: Fair View High School (FKA Partridge Elementary School)

Building: D - Restrooms & Custodial Room (FKA A)

Material Class	Material	Homo. Mat. #	% Asb.	Ft ² /L.F.	Location	Condition: Code & Comments	Friable Yes/No
S	ACOUSTIC CEILING PLASTER	5	1-5%	1,000 S	RESTROOMS, CUSTODIAL ROOMS, AND BOILER ROOM	(1)	N
T	LARGE MUD JOINT	6	ASSUMED	22 JOINTS	BOILER ROOM	(1) (4)	N
T	SMALL MUD JOINT	7	ASSUMED	26 JOINTS	BOILER ROOM	(1) (4)	N
S	WALL PLASTER	31	ASSUMED	400 S	RESTROOMS	(1)	N

CONDITION CODE

General Condition: (1) Good (2) Damaged (3) Significantly Damaged (25% or more)
 Change in Condition: (4) No (5) Yes (If Yes, explain under comments)
 Abated: (6) Repaired (7) Removed (8) Encapsulated (9) Enclosed (10) Isolated & Restricted
 Miscellaneous: (11) Inaccessible, no inspection data (12) Other (Explain under comments) (13) Non-Asbestos/Not Inspected

CONSULT ORIGINAL AND SUPPLEMENTARY INSPECTION REPORTS FOR MATERIALS WITH TRACE AMOUNTS OF ASBESTOS

**THREE-YEAR REINSPECTION
HOMOGENEOUS ACBM RECORDS**

Date of Inspection: May 10, 2007

District: Chico Unified School District

Inspector: William Esparza

School: Fair View High School (FKA Partridge Elementary School)

Building: E - Classrooms 7-10 (FKA A)

Material Class	Material	Homo. Mat. #	% Asb.	F ² /L.F.	Location	Condition: Code & Comments	Friable Yes/No
M	9" VFT BEIGE	4	1-5%	4,500 S	CLASSROOMS 7-10, WORK ROOM AND STAFF RESTROOMS	(1) (4)	N
S	ACOUSTIC CEILING PLASTER	5	1-5%	5,000 S	CLASSROOMS 7-10, WORK ROOM, AND STAFF RESTROOMS	(1) (4)	N

CONDITION CODE

General Condition: (1) Good (2) Damaged (3) Significantly Damaged (25% or more)
Change in Condition: (4) No (5) Yes (If Yes, explain under comments)
Abated: (6) Repaired (7) Removed (8) Encapsulated (9) Enclosed (10) Isolated & Restricted
Miscellaneous: (11) Inaccessible, no inspection data (12) Other (Explain under comments) (13) Non-Asbestos/Not Inspected

CONSULT ORIGINAL AND SUPPLEMENTARY INSPECTION REPORTS FOR MATERIALS WITH TRACE AMOUNTS OF ASBESTOS

THREE-YEAR REINSPECTION HOMOGENEOUS ACBM RECORDS

Date of Inspection: May 10, 2007

District: Chico Unified School District

Inspector: William Esparza

School: Fair View High School (FKA Partridge Elementary School)

Building: G - Classrooms 11-14 (FKA B)

Material Class	Material	Homo. Mat. #	% Asb.	Ft ² /L.F.	Location	Condition: Code & Comments	Frable Yes/No
M	9" VFT	4	1-5%	4,500 S	CLASSROOMS 11-14	(1) (4) (6) ROOM 13 REPAIRED 2/00 WORK ORDER NUMBER E23746.	N
S	ACOUSTIC CEILING PLASTER	5	1-5%	5,000 S	ALL CLASSROOMS AND BOTH RESTROOMS	(1) (4) (7) CUSTODIAL ROOM.	N N/A
S	WALL PLASTER	31	ASSUMED	1,200 S	CUSTODIAL ROOM AND RESTROOMS	(1)	N

CONDITION CODE

General Condition: (1) Good (2) Damaged (3) Significantly Damaged (25% or more)
Change in Condition: (4) No (5) Yes (If Yes, explain under comments)
Abated: (6) Repaired (7) Removed (8) Encapsulated (9) Enclosed (10) Isolated & Restricted
Miscellaneous: (11) Inaccessible, no inspection data (12) Other (Explain under comments) (13) Non-Asbestos/Not Inspected

CONSULT ORIGINAL AND SUPPLEMENTARY INSPECTION REPORTS FOR MATERIALS WITH TRACE AMOUNTS OF ASBESTOS

**THREE-YEAR REINSPECTION
HOMOGENEOUS ACBM RECORDS**

Date of Inspection: May 10, 2007

District: Chico Unified School District

Inspector: William Esparza

School: Fair View High School (FKA Partridge Elementary School)

Building: F - MPR (911) (FKA C)

Material Class	Material	Homo. Mat. #	% Asb.	Ft ² /L.F.	Location	Condition: Code & Comments	Frable Yes/No
T	PIPE WRAP STRAIGHT	3	70-75%	150 L	KITCHEN, WATER HEATER ROOM, MPR STORAGE, AND CUSTODIAL ROOM	(9)	N
M	9" VFT	4	1-5%	6,000 S	MPR, KITCHEN, AND ADMINISTRATION	(1) (4)	N
S	ACOUSTIC CEILING PLASTER	5	1-5%	1,400 S	HALLWAY OUTSIDE MPR	(1) (4)	N
T	MUD JOINT	7	ASSUMED	20 JOINTS	KITCHEN, WATER HEATER ROOM, MPR STORAGE, AND CUSTODIAL ROOM	(1) (4)	N
M	12" ACT	30	ASSUMED	UNDETERMINED	MPR	(1)	N
M	TRANSITE PIPE	99	ASSUMED	6 L	KITCHEN WATER HEATER ROOM	(1) (4)	N

CONDITION CODE

General Condition: (1) Good (2) Damaged (3) Significantly Damaged (25% or more)
Change in Condition: (4) No (5) Yes (If Yes, explain under comments)
Abated: (6) Repaired (7) Removed (8) Encapsulated (9) Enclosed (10) Isolated & Restricted
Miscellaneous: (11) Inaccessible, no inspection data (12) Other (Explain under comments) (13) Non-Asbestos/Not Inspected

CONSULT ORIGINAL AND SUPPLEMENTARY INSPECTION REPORTS FOR MATERIALS WITH TRACE AMOUNTS OF ASBESTOS

THREE-YEAR REINSPECTION HOMOGENEOUS ACBM RECORDS

Date of Inspection: May 10, 2007

District: Chico Unified School District

Inspector: William Esparza

School: Fair View High School (FKA Partridge Elementary School)

Building: H - Classroom 17 (FKA D)

Material Class	Material	Homo. Mat. #	% Asb.	Ft ² /L.F.	Location	Condition: Code & Comments	Frable Yes/No
M	LINOLEUM BEIGE	10	NONE DETECTED	100 S	GIRL'S & BOY'S RESTROOMS	(13) SAMPLE HMS-PAR-08 COLLECTED ON 3-30-88.	N/A
M	DRYWALL & JOINT COMPOUND	32	ASSUMED	1,800 S	CLASSROOM 17 AND GIRL'S & BOY'S RESTROOMS	(1)	N
M	2' X 4' FCP'S	65	NONE DETECTED	900 S	CLASSROOM 17	(13) SAMPLE HMS-CUSD-PART-200A COLLECTED 4-11-95.	N/A
M	12" VFT CREAM	103	ASSUMED	120 S	CLASSROOM 17	(1)	N
M	12" VFT CREAM	103	ASSUMED	600 S	CLASSROOM 17	(1) (4)	N

CONDITION CODE

General Condition: (1) Good (2) Damaged (3) Significantly Damaged (25% or more)
Change in Condition: (4) No (5) Yes (If Yes, explain under comments)
Abated: (6) Repaired (7) Removed (8) Encapsulated (9) Enclosed (10) Isolated & Restricted
Miscellaneous: (11) Inaccessible, no inspection data (12) Other (Explain under comments) (13) Non-Asbestos/Not Inspected

CONSULT ORIGINAL AND SUPPLEMENTARY INSPECTION REPORTS FOR MATERIALS WITH TRACE AMOUNTS OF ASBESTOS

THREE-YEAR REINSPECTION HOMOGENEOUS ACBM RECORDS

Date of Inspection: May 10, 2007

District: Chico Unified School District

Inspector: William Esparza

School: Fair View High School (FKA Partridge Elementary School)

Building: I (FKA D)

Material Class	Material	Homo. Mat. #	% Asb.	Ft ² /L.F.	Location	Condition: Code & Comments	Friable Yes/No
M	DRYWALL & JOINT COMPOUND	32	ASSUMED	2,500 S	ROOMS 15 & 16	(11) COVERED WITH TAGBOARD.	N
M	2' X 4' FCP'S	65	NONE DETECTED	1,800 S	ROOMS 15 & 16	(13) SAMPLE HMS-CUSD-PART-200A COLLECTED 4-11-95.	N/A
M	12" VFT CREAM	103	ASSUMED	240 S	ROOMS 15 & 16	(1) (4)	N

CONDITION CODE

General Condition: (1) Good (2) Damaged (3) Significantly Damaged (25% or more)
Change in Condition: (4) No (5) Yes (If Yes, explain under comments)
Abated: (6) Repaired (7) Removed (8) Encapsulated (9) Enclosed (10) Isolated & Restricted
Miscellaneous: (11) Inaccessible, no inspection data (12) Other (Explain under comments) (13) Non-Asbestos/Not Inspected

CONSULT ORIGINAL AND SUPPLEMENTARY INSPECTION REPORTS FOR MATERIALS WITH TRACE AMOUNTS OF ASBESTOS

THREE-YEAR REINSPECTION HOMOGENEOUS ACBM RECORDS

Date of Inspection: May 10, 2007

District: Chico Unified School District

Inspector: William Esparza

School: Fair View High School (FKA Partridge Elementary School)

Building: J (FKA D)

Material Class	Material	Homo. Mat. #	% Asb.	F ² /L.F.	Location	Condition: Code & Comments	Friable Yes/No
M	2' X 8' ACT WOOD	50	NON-SUSPECT	480 S	SFA TRAILER (916) AND SPEECH TRAILER	(13)	N/A
M	2' X 4' FCP'S	65	NONE DETECTED	900 S	LIBRARY/COMPUTER ROOM (917)	(13) SAMPLE HMS-CUSD-PART-200A COLLECTED 4-11-95.	N/A
M	DRYWALL	66	NONE DETECTED	400 S	COMPUTER ROOM (917)	(13) SAMPLE HMS-CUSD-PART-201A COLLECTED 4-11-95.	N/A

CONDITION CODE

General Condition: (1) Good (2) Damaged (3) Significantly Damaged (25% or more)
 Change in Condition: (4) No (5) Yes (If Yes, explain under comments)
 Abated: (6) Repaired (7) Removed (8) Encapsulated (9) Enclosed (10) Isolated & Restricted
 Miscellaneous: (11) Inaccessible, no inspection data (12) Other (Explain under comments) (13) Non-Asbestos/Not Inspected

CONSULT ORIGINAL AND SUPPLEMENTARY INSPECTION REPORTS FOR MATERIALS WITH TRACE AMOUNTS OF ASBESTOS

**THREE-YEAR REINSPECTION
HOMOGENEOUS ACBM RECORDS**

Date of Inspection: May 10, 2007

District: Chico Unified School District

Inspector: William Esparza

School: Fair View High School (FKA Partridge Elementary School)

Building: K - Portables 18 & 19

Material Class	Material	Homo. Mat. #	% Asb.	Ft ² /L.F.	Location	Condition: Code & Comments	Friable Yes/No
M	DRYWALL & JOINT COMPOUND	32	ASSUMED	2,500 S	PORTABLES 18 & 19	(11) COVERED WITH TAGBOARD.	N
M	12" VFT	51	ASSUMED	300 S	PORTABLES 18 & 19	(1) (4)	N
M	2' X 4' FCP'S	52	ASSUMED	1,800 S	PORTABLES 18 & 19	(1) (4)	N

CONDITION CODE

General Condition: (1) Good (2) Damaged (3) Significantly Damaged (25% or more)
Change in Condition: (4) No (5) Yes (If Yes, explain under comments)
Abated: (6) Repaired (7) Removed (8) Encapsulated (9) Enclosed (10) Isolated & Restricted
Miscellaneous: (11) Inaccessible, no inspection data (12) Other (Explain under comments) (13) Non-Asbestos/Not Inspected

CONSULT ORIGINAL AND SUPPLEMENTARY INSPECTION REPORTS FOR MATERIALS WITH TRACE AMOUNTS OF ASBESTOS

THREE-YEAR REINSPECTION HOMOGENEOUS ACBM RECORDS

Date of Inspection: May 10, 2007

District: Chico Unified School District

Inspector: William Esparza

School: Fair View High School (FKA Partridge Elementary School)

Building: A - Unit 1

Material Class	Material	Homo. Mat. #	% Asb.	Ft ² /L.F.	Location	Condition: Code & Comments	Frangible Yes/No
M	2' X 4' FCP'S	53	ASSUMED	900 S	PORTABLE 1	(1) (4)	N
M	12" VFT CREAM	61	ASSUMED	300 S	PORTABLE 1 - EAST SIDE	(1) (4) SLIGHT CRACKS AT ENTRY WAY.	N
M	12" VFT CREAM	90	ASSUMED	600 S	PORTABLE 1 - WEST SIDE	(1)	N
M	LINOLEUM TAN	100	ASSUMED	60 S	LAUNDRY AND GIRL'S & BOY'S RESTROOMS	(1) (4)	N
M	GYPSUM BOARD	101	ASSUMED	300 S	LAUNDRY AND GIRL'S & BOY'S RESTROOMS	(1) (4)	N
M	GYPSUM BOARD	101	ASSUMED	2,000 S	PORTABLE 1	(11) COVERED WITH TAGBOARD.	N

CONDITION CODE

General Condition: (1) Good (2) Damaged (3) Significantly Damaged (25% or more)
 Change in Condition: (4) No (5) Yes (If Yes, explain under comments)
 Abated: (6) Repaired (7) Removed (8) Encapsulated (9) Enclosed (10) Isolated & Restricted
 Miscellaneous: (11) Inaccessible, no inspection data (12) Other (Explain under comments) (13) Non-Asbestos/Not Inspected

CONSULT ORIGINAL AND SUPPLEMENTARY INSPECTION REPORTS FOR MATERIALS WITH TRACE AMOUNTS OF ASBESTOS

**THREE-YEAR REINSPECTION
HOMOGENEOUS ACBM RECORDS**

Date of Inspection: May 10, 2007

District: Chico Unified School District

Inspector: William Esparza

School: Fair View High School (FKA Partridge Elementary School)

Building: B - Portable 2

Material Class	Material	Homo. Mat. #	% Asb.	Ft ² /L.F.	Location	Condition: Code & Comments	Friable Yes/No
S	ACOUSTIC CEILING PLASTER	5	ASSUMED	1,000 S	ROOM 2 - UNIT B	(1)	N
S	WALL PLASTER	31	ASSUMED	UNDETERMINED	PORTABLE 2	(1)	N
M	2' X 4' FCP'S	55	ASSUMED	600 S	PORTABLE 2	(7) PLASTER CEILING.	N/A
M	9" VFT GREEN	63	ASSUMED	200 S	PORTABLE 2	(1) (4)	N

CONDITION CODE

General Condition: (1) Good (2) Damaged (3) Significantly Damaged (25% or more)
Change in Condition: (4) No (5) Yes (If Yes, explain under comments)
Abated: (6) Repaired (7) Removed (8) Encapsulated (9) Enclosed (10) Isolated & Restricted
Miscellaneous: (11) Inaccessible, no inspection data (12) Other (Explain under comments) (13) Non-Asbestos/Not Inspected

CONSULT ORIGINAL AND SUPPLEMENTARY INSPECTION REPORTS FOR MATERIALS WITH TRACE AMOUNTS OF ASBESTOS

THREE-YEAR REINSPECTION HOMOGENEOUS ACBM RECORDS

Date of Inspection: May 10, 2007

District: Chico Unified School District

Inspector: William Esparza

School: Fair View High School (FKA Partridge Elementary School)

Building: L - Portable 20

Material Class	Material	Homo. Mat. #	% Asb.	Ft ² /L.F.	Location	Condition: Code & Comments	Friable Yes/No
M	DRYWALL & JOINT COMPOUND	32	ASSUMED	1,250 S	PORTABLE 20	(11) COVERED WITH TAGBOARD.	N
M	2' X 4' FCP'S FIBERGLASS	54	NON-SUSPECT	600 S	PORTABLE 20	(13)	N/A
M	12" VFT WHITE	62	ASSUMED	900 S	PORTABLE 20	(1) (4)	N

CONDITION CODE

General Condition: (1) Good (2) Damaged (3) Significantly Damaged (25% or more)
Change in Condition: (4) No (5) Yes (If Yes, explain under comments)
Abated: (6) Repaired (7) Removed (8) Encapsulated (9) Enclosed (10) Isolated & Restricted
Miscellaneous: (11) Inaccessible, no inspection data (12) Other (Explain under comments) (13) Non-Asbestos/Not Inspected

CONSULT ORIGINAL AND SUPPLEMENTARY INSPECTION REPORTS FOR MATERIALS WITH TRACE AMOUNTS OF ASBESTOS

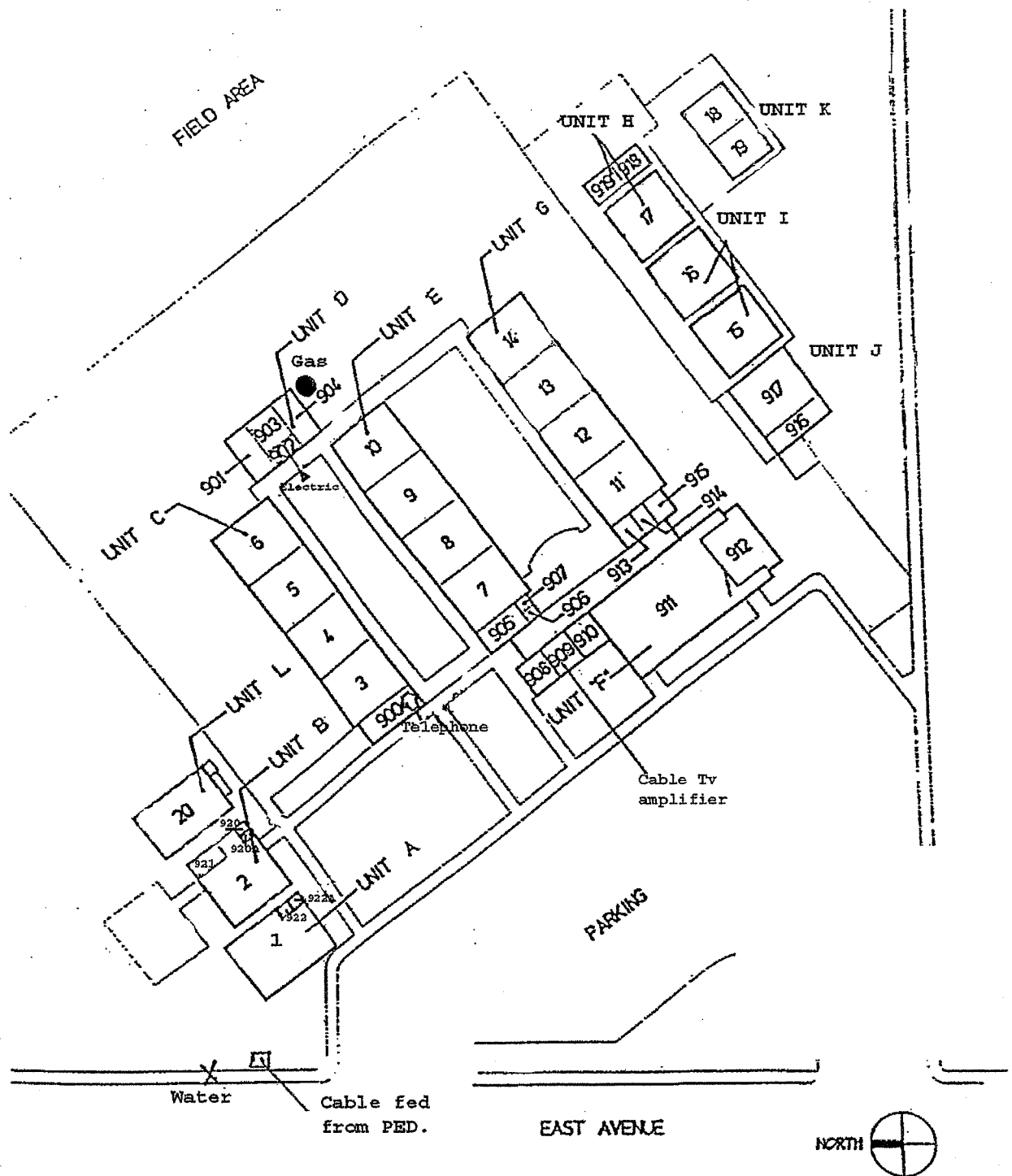

FAIR VIEW HIGH SCHOOL (at Jay Partridge site)

Updated 9/2006

THREE-YEAR REINSPECTION
CONDUCTED BY WILLIAM ESPARZA
OF ENTEK CONSULTING GROUP, INC.
ON MAY 10, 2007